



Effective January, 2008

BRADBURY & BRADBURY DESIGN SERVICE

Our Design Service gives architects, designers, and homeowners individualized access to our in-house trained designer. Working together with the client, our designer will conceptualize and provide detailed design drawings of the ceiling plan and a typical wall elevation or panelized walls for any room at 3/4" = 1'-0" scale. Each decorative scheme is uniquely adapted to its specific architectural space and the client's requirements. To make the ordering process as effortless as possible, Design Service will provide you with a quantity and cost estimate and can place your printing order upon your approval of the design. Please note that all orders must be paid in advance of printing.

PREPARING TO USE DESIGN SERVICE

Before contacting Design Service, we recommend that you familiarize yourself with the various designs presented in our catalog and/or on our website, www.bradbury.com. For clarity, our collections are arranged in individual roomsets. We try to work with the patterns and colors selected as favorites in advance by the client. Final color and pattern preferences are, of course, the decision of the client, but we are pleased to make additional suggestions or recommendations, as needed.

We generally recommend that you select and purchase actual samples of the patterns and colorways that are of greatest interest. The color images on our website and in our catalog serve as general guides only. Sample orders may be placed with either Design Service, Customer Service, or on our website. Rest assured, we are always happy to give you advice by phone if you would like some preliminary guidance.

GETTING STARTED

A complete and accurate description of the space to be ornamented is the key to a successful design and installation. We have created a checklist to ensure that we have all the necessary information in order to proceed. To initiate a Design Service project, complete the Design Service Form and mail or fax to:

Design Department
Bradbury & Bradbury Wallpapers
P.O. Box 155
Benicia, CA 94510
Phone: (707) 746-1900
Fax: (707) 745-9417

If you have any questions, please give us a call. Design Service hours are 9:00 a.m. to 5 p.m., Pacific Time, Monday through Friday.

FEES

Design Service fees for detailed layout drawings are as follows:

- Detailed scale drawing = \$600 flat fee per room
(includes samples, quantity estimate, and price & shipping quote)
- Color consultation = Starting at \$50 per room

Please note:

- Fees are not applicable toward your paper order and are payable in advance of Design Service.
- For more complex rooms, an additional fee may be assessed at the designers' discretion.

SCHEDULING

There is normally a backlog for Design Service; you can check on the current lead time by phone, or you will be advised by mail once we have received your checklist and fee. Once you have approved the design drawing and have placed your prepaid print order, your papers will be hand printed. Production lead time varies and will be quoted when your order is placed. Shipping is by UPS ground service and takes 7-10 working days; please let us know if you would like a price quote for expedited shipping.

INSTALLATION

The measured drawings produced by Design Service are for design approval, but they are also meant to serve as a guide for hanging the papers. We have found that a surprising number of clients enjoy hanging their own papers; others prefer to rely on professional paperhangers. We recommend that the paperhanger confirm required quantities on site, as hanging techniques vary. To find a professional installer in your area, we recommend contacting the National Guild of Professional Paperhangers at www.ngpp.org.

AND IN CLOSING. . .

Besides being an indispensable help, Design Service can be fun too! Our designer will do everything possible to make your ornamental interior surpass your expectations.

DESIGN SERVICE CHECKLIST

INSTRUCTIONS: Please complete this checklist and return to us along with your fee, as outlined below. Please make copies of all information sent to us in case we need to verify details.

Name: _____

Street Address: _____

City: _____ State/Prov.: _____

Zip/Postal Code: _____ Country: _____

Telephone - Day: _____ Evening: _____

E-mail Address: _____

Room(s) to be designed: _____

Fee enclosed: \$600 flat fee/room: _____

.....
1. Building Description/Date: _____

2. Room Description/Function (please enclose photos): _____

3. Roomset(s) Preferred: _____

Receptive to Mix & Match between Roomsets? Y _____ N _____

Specific Patterns Preferred: _____

Specific Patterns to Avoid: _____

4. Color Series Preferred: _____

Samples Enclosed - if applicable (Paint Chips, Fabric/Carpet): _____

Adjacent Areas and Their Color Schemes: _____

Will you need a Color Consultation for Paint? (additional fee required)

5. PROVIDE A FLOORPLAN SKETCH indicating overall room dimensions taken at the widest and longest points, and include floor-to-ceiling height. A print of an architectural floor plan, with wall elevations and dimensions, is ideal if available. Otherwise, a simple sketch with the respective measurements will be sufficient.

❖ Floor and Wall Features Sketch*:

- Perimeter measurements (including door and window widths)
- "Overall" room measurements (at longest and widest points)
- Wall Sketch showing overall height of room from floor to ceiling. Include measurements from above doors to ceiling and above and below windows
- Measurements/descriptions of any wood or plaster moldings, baseboards or wainscoting
- Indicate room directional orientation (North, South, East, West)

❖ Ceiling Features Sketch*:

- Crown Molding and Dimensions: Height _____ Depth _____
- Is there a Ceiling fixture? Show exact location
- Is there an existing plaster rosette? _____ To be installed? _____
Diameter of rosette: _____
- Would you prefer a paper medallion design?

* See included "Guide to measuring your room" drawing

6. Are there any special architectural features such as beams, brackets, mantle pieces, tray or dropped ceilings, stained or leaded glass windows, fretwork, niches, inglenooks, arches, columns, built-ins, etc.? Please provide their location and dimensions.
7. Is there anything else you'd like us to know about your room or the project in general? If so, please feel free to add your own comments. If you have any questions about the checklist, give us a call and we will happily talk you through it!

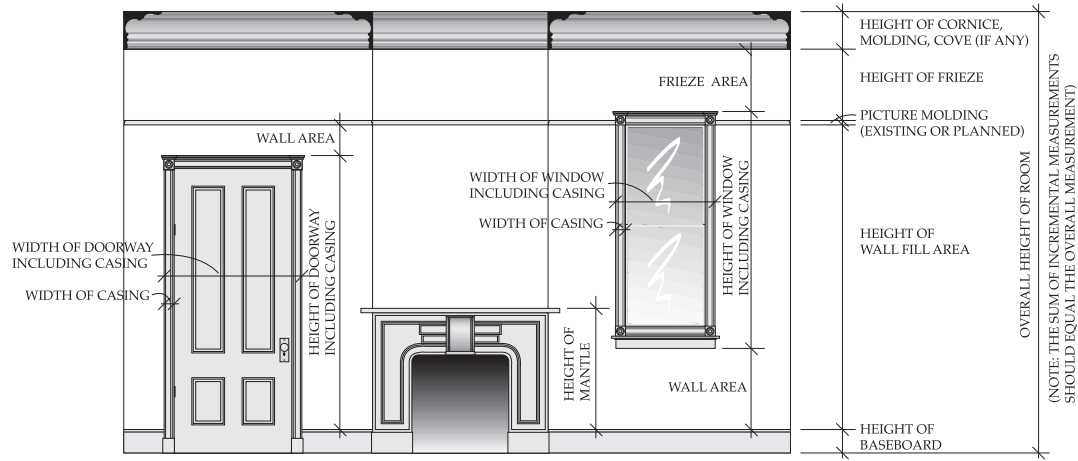

WALL ELEVATION INFORMATION

(NOTE: NEEDED FOR ALL WALLS)

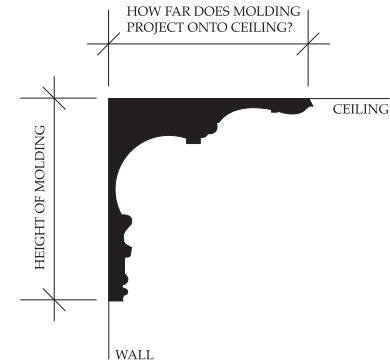

CORNICE MOLDING INFO. DETAIL

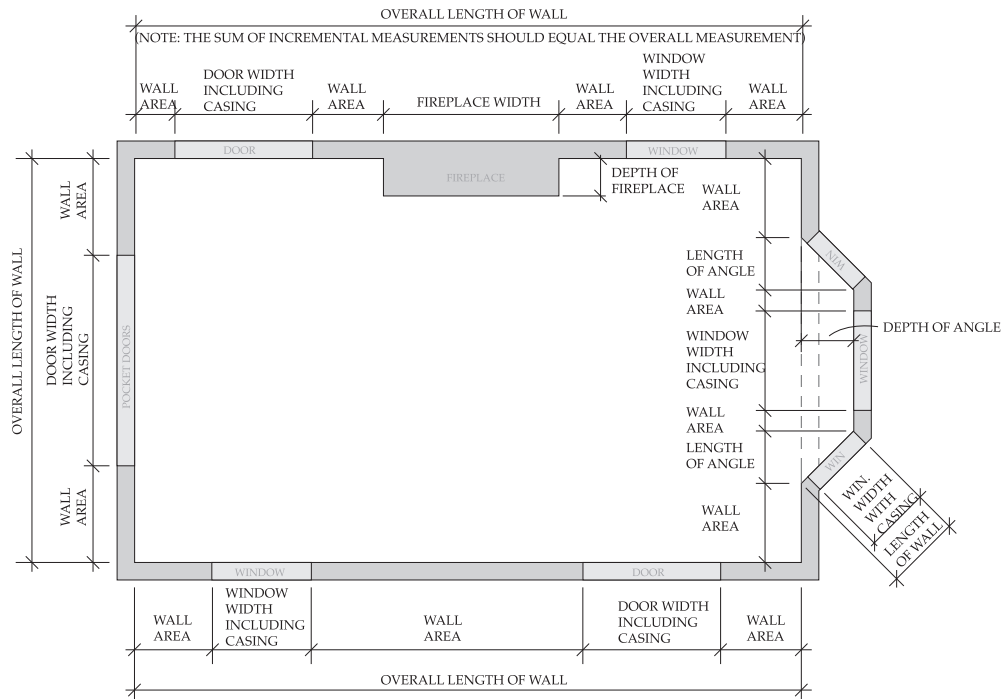

CEILING PLAN INFORMATION

(NOTE: CEILING DIMENSIONS MAY BE TAKEN FROM THE FLOOR. MEASURE THE OVERALL LENGTH OF EACH WALL, AND THE INCREMENTAL WIDTHS OF ITS VARIOUS COMPONENTS SUCH AS WINDOWS, DOORS, ETC.)

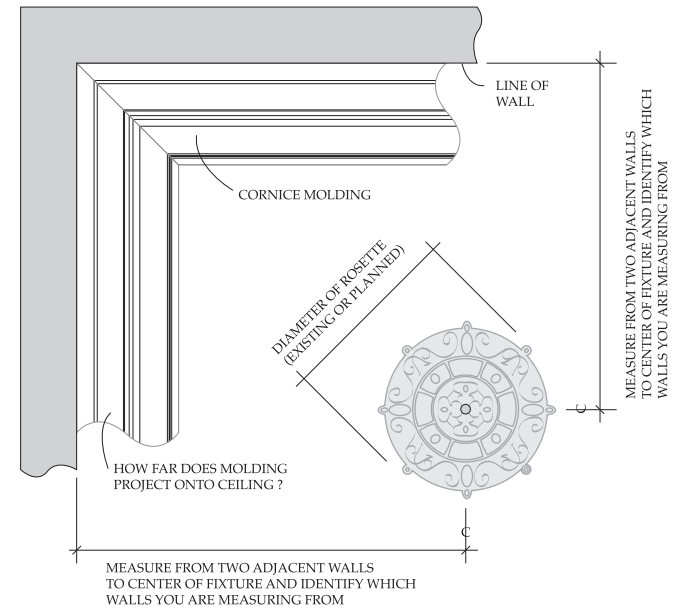

CEILING INFORMATION DETAIL

GUIDE TO MEASURING YOUR ROOM

(NOTE: ROOM SIZES, SHAPES, AND DETAILS WILL VARY GREATLY. WE HAVE INCLUDED SOME TYPICAL FEATURES TO CONSIDER, WHICH MAY NOT NECESSARILY APPLY TO YOUR ROOM.)

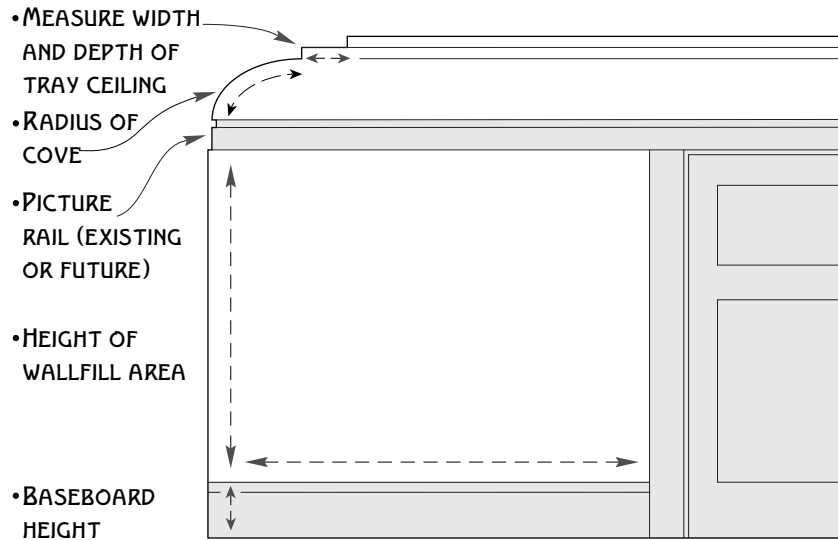

WALL ELEVATION INFORMATION

OVERALL FLOOR TO CEILING HEIGHT

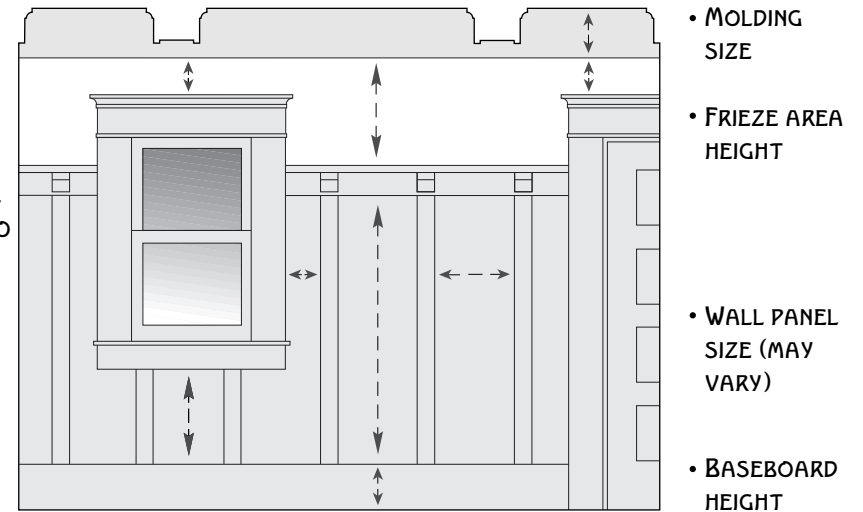

BOARD & BATTEN WALL DETAIL

NOTE: IS THERE AN ARCH OR A BAY? WHAT IS ITS WIDTH AND DEPTH?

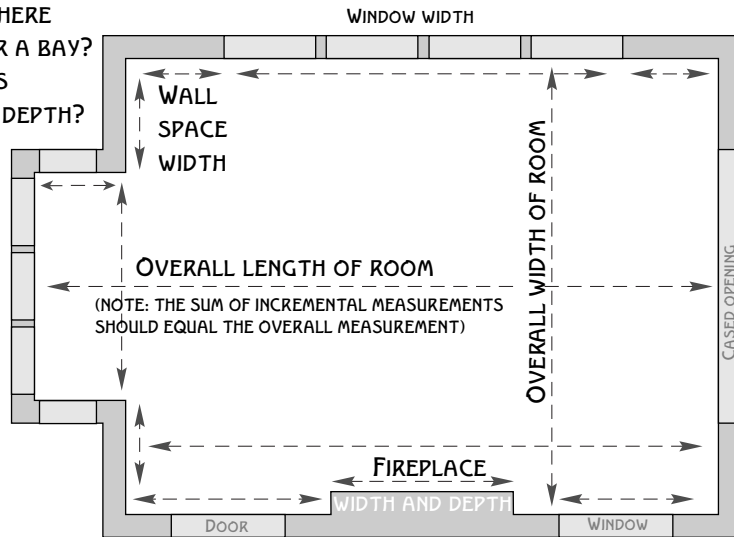

ROOM INFORMATION:

MEASURE THE OVERALL LENGTH OF EACH WALL AND THE INCREMENTAL WIDTHS OF ITS VARIOUS COMPONENTS (WINDOWS, DOORS, ETC.)

NORTH
INDICATE DIRECTIONAL ORIENTATION OF ROOM

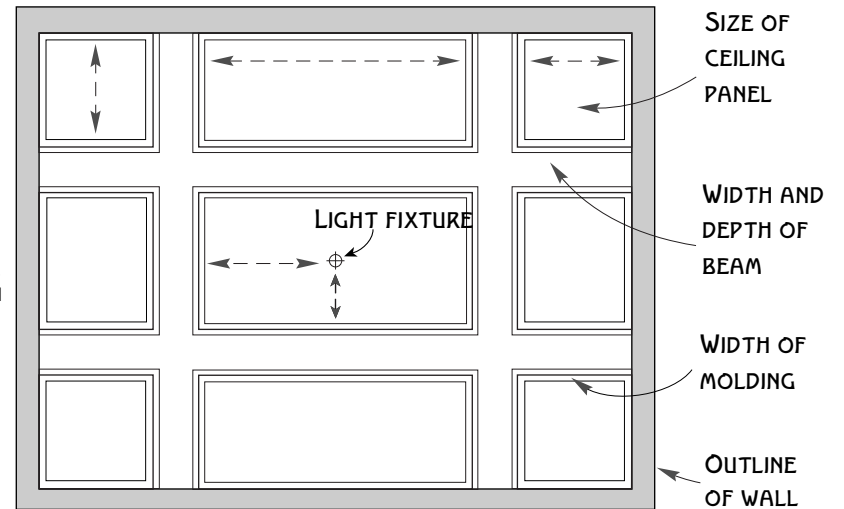

CEILING INFORMATION:

MEASURE LIGHT FIXTURE LOCATION FROM TWO ADJACENT WALLS TO CENTER OF FIXTURE.

GUIDE TO MEASURING YOUR ARTS & CRAFTS ROOM

(NOTE: ROOM SIZES, SHAPES, AND DETAILS WILL VARY GREATLY. WE HAVE INCLUDED SOME TYPICAL FEATURES TO CONSIDER, WHICH MAY NOT NECESSARILY APPLY TO YOUR ROOM.)